

Tie Rod, Inner, LH (Remove and Replace)

Labor Code: 101011010

Important:

This manual is written for professional automotive technicians who have received high voltage training. It is the technician's responsibility to make sure that the vehicle is safe to work on before beginning inspections or repairs, and to perform all work in a safe manner and in a safe work environment. Refer to the [Introduction](#) section for additional important information.

Torque Specifications:

Step Number	Torque (Nm)
2	80
5	88

Before performing this procedure, or if damage to the steering system is suspected, refer to: [Steering System Inspection and Replacement](#).

Removal

1. Remove: [Tie Rod, Outer, LH \(Remove and Replace\)](#).
- 2.

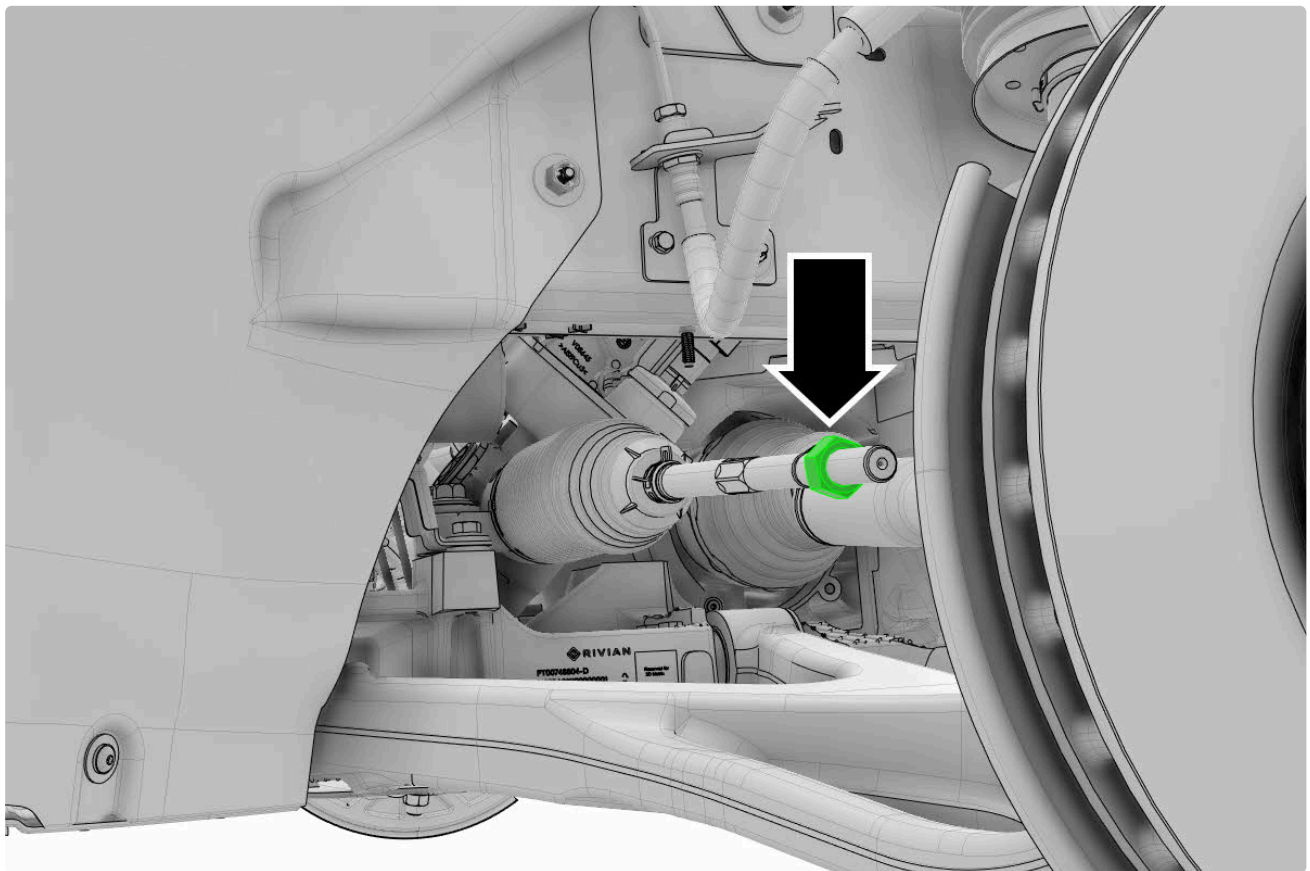

Torque: 80 Nm

3.

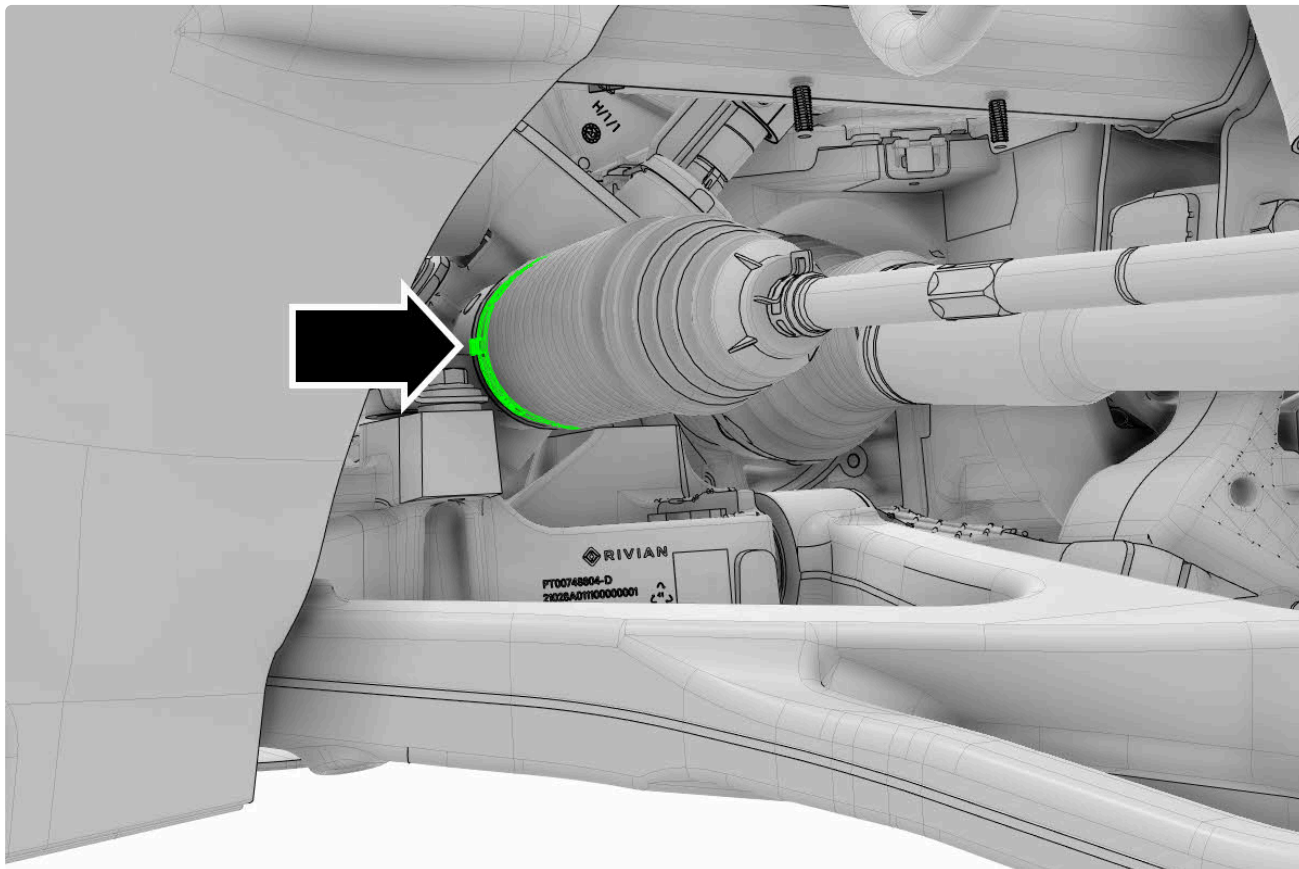

CAUTION:
Non-reusable component(s).

Note:
This component is not available separately. It is included with the main component.

4.

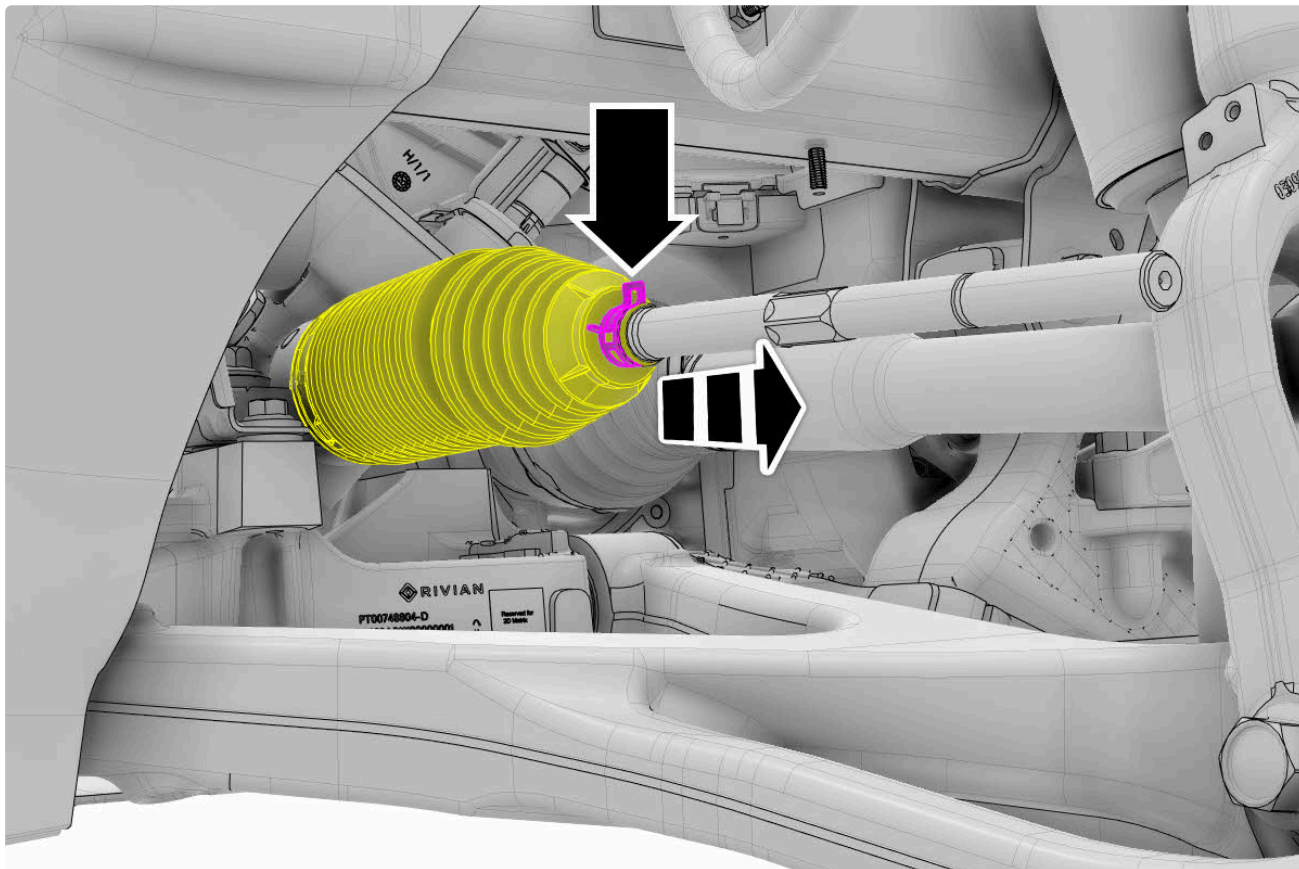

5. Using the inner tie rod tool: Remove the component.

Note:

[Refer to the special tool instructions for important information.](#)

Torque: 88 Nm

Installation

Installation is the reverse of removal, except for the following:

- Apply the grease that is included with the new component to the highlighted area(s).

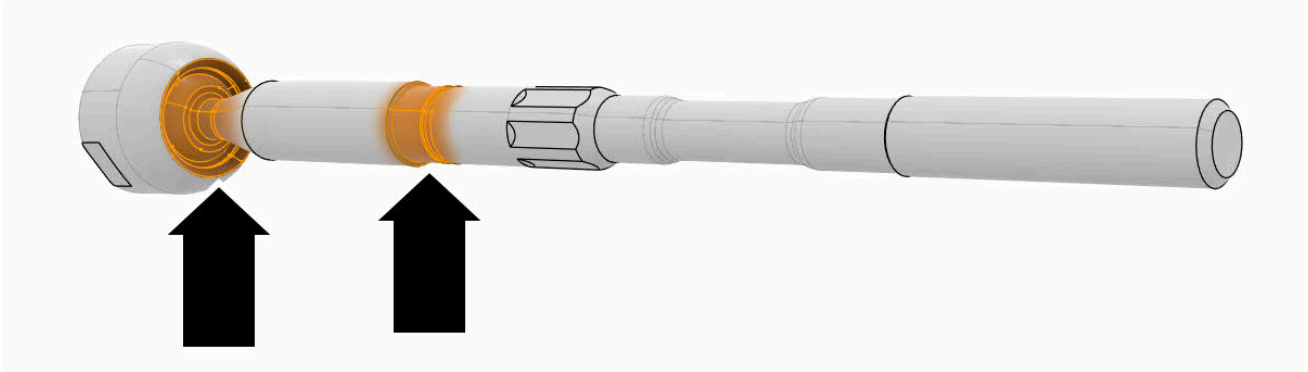

- Using offset boot clamp pliers: Install:

